



2007-2017 Jeep JK 2.5 Rear Bypass Shocks

King Shocks 12472 Edison Way Garden Grove, CA 92841
714-530-8701 www.kingshocks.com

Rear Parts List:

- 2 – 2.5 Remote Reservoir Bypass Shocks (25001-342)
- 1 – Reservoir Bracket, Left Rear (25044-113)
- 1 – Reservoir Bracket, Right Rear (25044-114)
- 4 – Hose Clamps (62024)

Tools Required:

- Floor Jack/Jack Stands
- Metric Wrench/Socket Set
- Standard Wrench/Socket Set

2007-2017 Jeep Wrangler JK
DEM PERFORMANCE SERIES



Shown with optional
quick adjust knobs.

REAR: With the vehicle on level ground, block the front tires. Using a floor jack, raise the rear end and support the frame rails with jack stands for safety. Remove rear tires. **NOTE: Never work under an unsupported vehicle.**

1. Remove the factory or existing rear shocks on each side by removing the bolts from the upper mounts and the through bolt and nut on the lower axle mount.
2. Before Installing your King Shocks check for the label that designates which side of the vehicle it fits on. The mounting bracket is longer on one side than the other. When installed properly the longer side goes towards the sway bar as shown. Use the factory bolts to secure the upper mounting bracket.

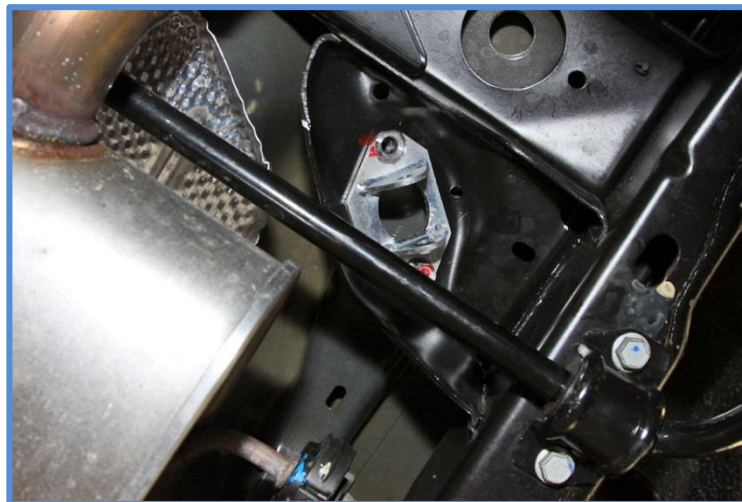

IMPORTANT: Read all instructions thoroughly from start to finish before beginning the install. Check parts list and make sure all parts are included in the kit. If the instructions are not properly followed severe frame, driveline and/or suspension damage may result. Check for frame and suspension damage prior to installation.

This kit does not require welding. Do not weld on any component. Welding may void the warranty and/or cause the product to fail. If any parts are missing, or for tech assistance; Contact King Off Road Racing Shocks: 714-530-8701 Most important after the install, Feel the difference and have fun.

2007-2017 Jeep JK 2.5 Rear Bypass Shocks

King Shocks 12472 Edison Way Garden Grove, CA 92841
714-530-8701 www.kingshocks.com

3. Remove the rear bolt from the sway bar frame mount bracket and loosen the front bolt to make installing the reservoir bracket easier.

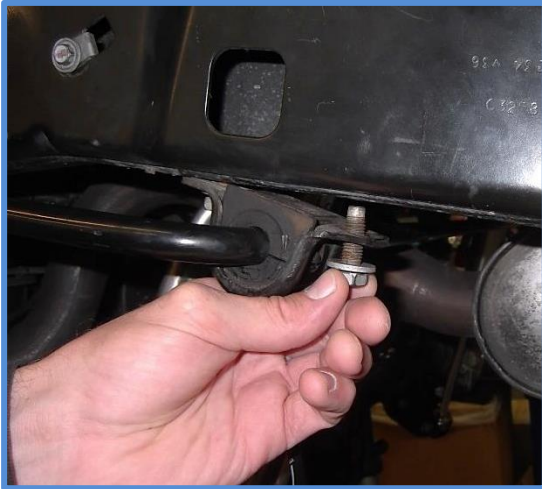

4. On the left side, unclip the wire loom from the frame.

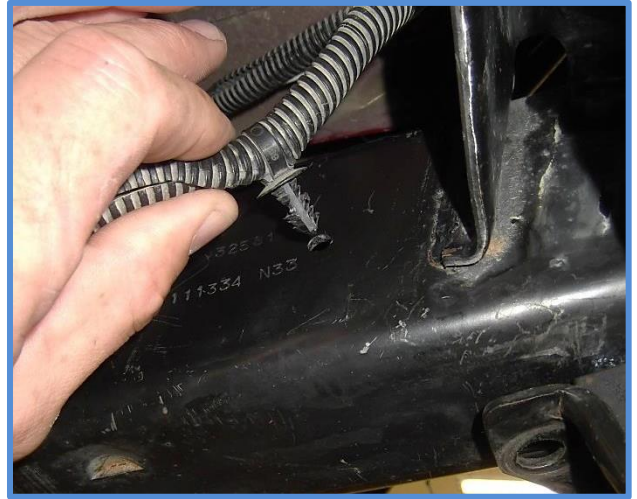

5. Before mounting the shock you will want to route the reservoirs up over the frame and pull out as much hose as possible, then get the reservoir brackets in place while you have the shock free.

Be aware that the shocks are side specific and can only be installed one way.

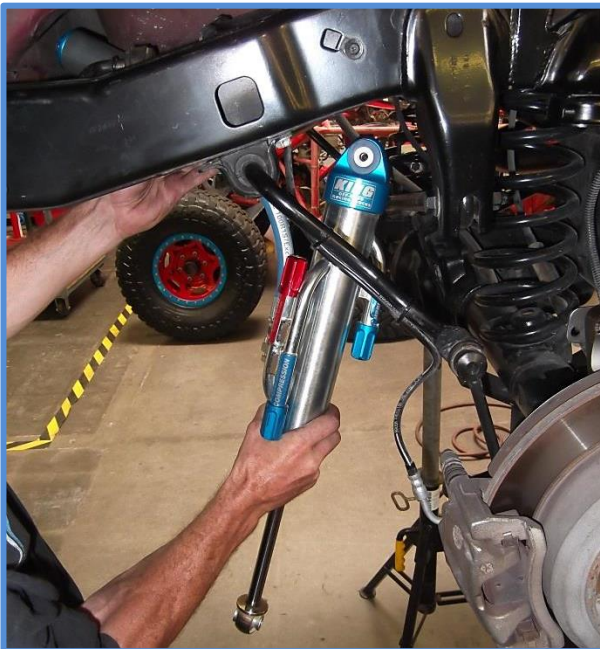

IMPORTANT: Read all instructions thoroughly from start to finish before beginning the install. Check parts list and make sure all parts are included in the kit. If the instructions are not properly followed severe frame, driveline and/or suspension damage may result. Check for frame and suspension damage prior to installation.

This kit does not require welding. Do not weld on any component. Welding may void the warranty and/or cause the product to fail. If any parts are missing, or for tech assistance; Contact King Off Road Racing Shocks: 714-530-8701 Most important after the install, Feel the difference and have fun.

2007-2017 Jeep JK 2.5 Rear Bypass Shocks

King Shocks 12472 Edison Way Garden Grove, CA 92841
714-530-8701 www.kingshocks.com

6. Reservoirs must be routed first, then place the bolt in the upper mount and tighten.

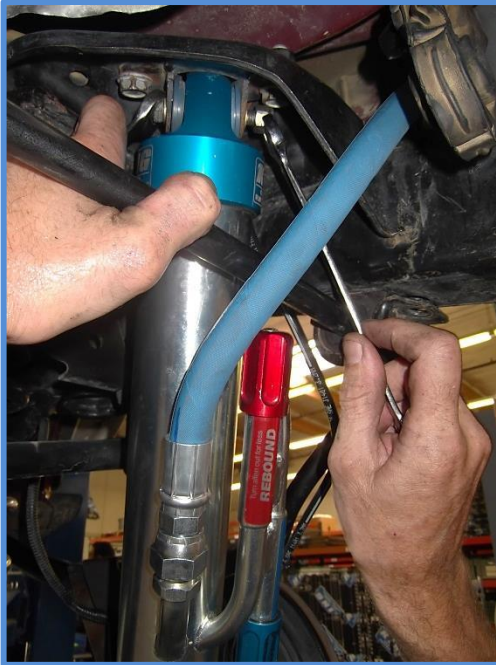

7. Place the reservoir brackets in position while getting the reservoirs in the cradle before putting the bracket in its final position.



8. Get the reservoir and reservoir bracket positioned like the photo below then bolt the reservoir bracket to the rear hole for the sway bar using the original sway bar bolt. Hold reservoir bracket tight to the back side of frame while tightening. Make sure both sway bar bolts are tight on both sides.

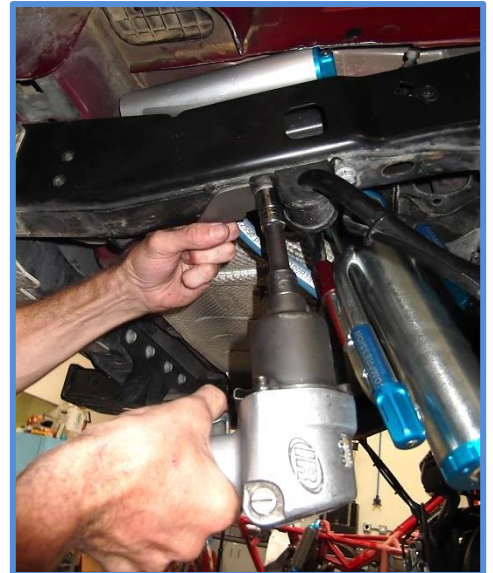

IMPORTANT: Read all instructions thoroughly from start to finish before beginning the install. Check parts list and make sure all parts are included in the kit. If the instructions are not properly followed severe frame, driveline and/or suspension damage may result. Check for frame and suspension damage prior to installation.

This kit does not require welding. Do not weld on any component. Welding may void the warranty and/or cause the product to fail. If any parts are missing, or for tech assistance; Contact King Off Road Racing Shocks: 714-530-8701 Most important after the install, Feel the difference and have fun.



2007-2017 Jeep JK 2.5 Rear Bypass Shocks

King Shocks 12472 Edison Way Garden Grove, CA 92841
714-530-8701 www.kingshocks.com

9. Place the reservoir in the bracket and push the reservoir back so it's not touching the frame. Use the provided hose clamps to secure the reservoir to the reservoir bracket.



10. With the reservoir secured, you can now connect the lower rod end to the lower shock mount using the factory hardware and tighten. Make sure the hose is in a nice loop and not twisting. Adjust if necessary.

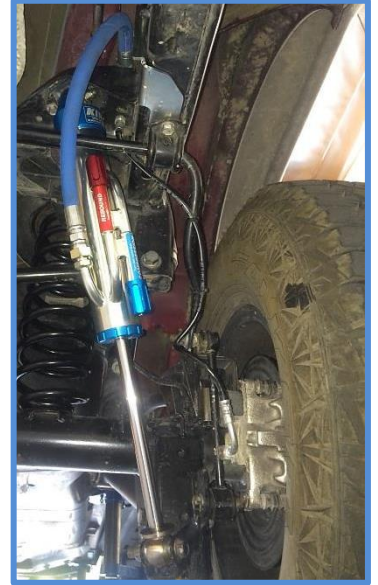

11. Install should be complete! Make sure hoses are routed properly and not touching any moving parts or exhaust, etc. Double check all hardware.

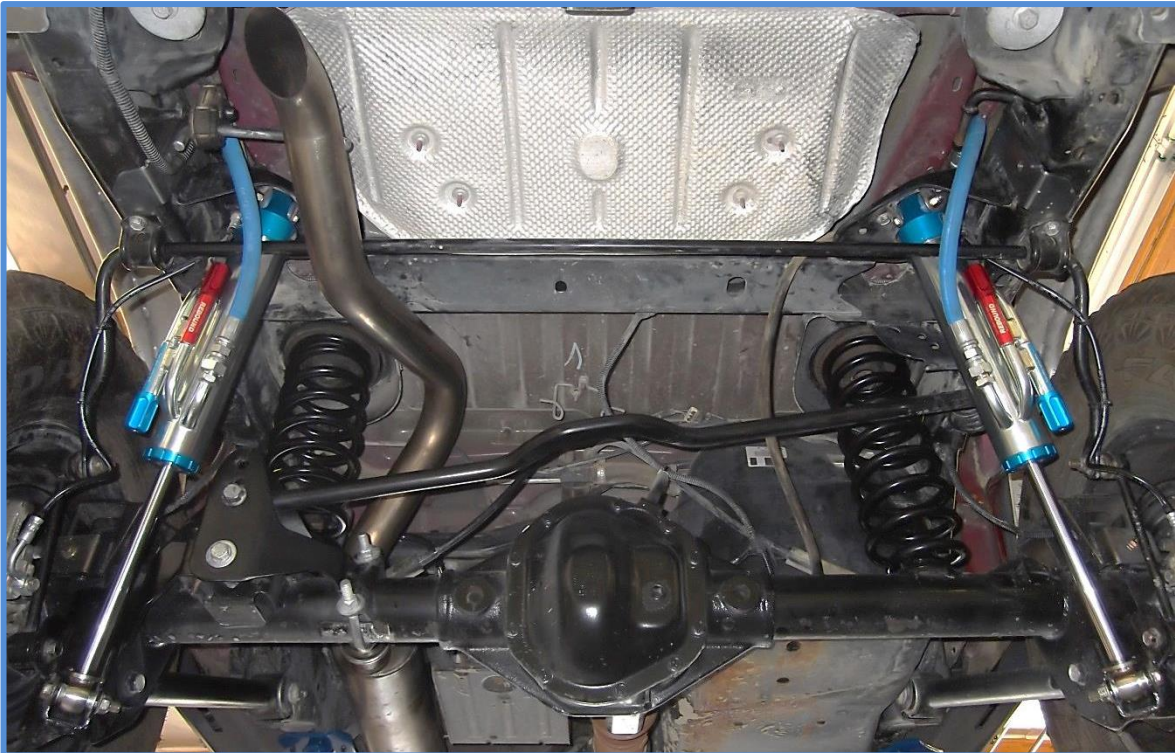

IMPORTANT: Read all instructions thoroughly from start to finish before beginning the install. Check parts list and make sure all parts are included in the kit. If the instructions are not properly followed severe frame, driveline and/or suspension damage may result. Check for frame and suspension damage prior to installation.

This kit does not require welding. Do not weld on any component. Welding may void the warranty and/or cause the product to fail. If any parts are missing, or for tech assistance; Contact King Off Road Racing Shocks: 714-530-8701 Most important after the install, Feel the difference and have fun.



2007-2017 Jeep JK 2.5 Rear Bypass Shocks

King Shocks 12472 Edison Way Garden Grove, CA 92841
714-530-8701 www.kingshocks.com

DOUBLE CHECK ALL HARDWARE:

Make sure everything is installed correctly and all hardware is tight before reinstalling tires. Install tires, remove jack stands and lower vehicle to the ground. Recheck all hardware and lug nuts after 100 miles and periodically after that as part of routine maintenance.

Left Rear



Right Rear



King Shocks
12472 Edison Way
Garden Grove, CA 92841
www.kingshocks.com

IMPORTANT: Read all instructions thoroughly from start to finish before beginning the install. Check parts list and make sure all parts are included in the kit. If the instructions are not properly followed severe frame, driveline and/or suspension damage may result. Check for frame and suspension damage prior to installation.

This kit does not require welding. Do not weld on any component. Welding may void the warranty and/or cause the product to fail. If any parts are missing, or for tech assistance; Contact King Off Road Racing Shocks: 714-530-8701 Most important after the install, Feel the difference and have fun.



2007-2017 Jeep JK 2.5 Rear Bypass Shocks

King Shocks 12472 Edison Way Garden Grove, CA 92841
714-530-8701 www.kingshocks.com

KING RECOMMENDED BYPASS ADJUSTER SETTING:

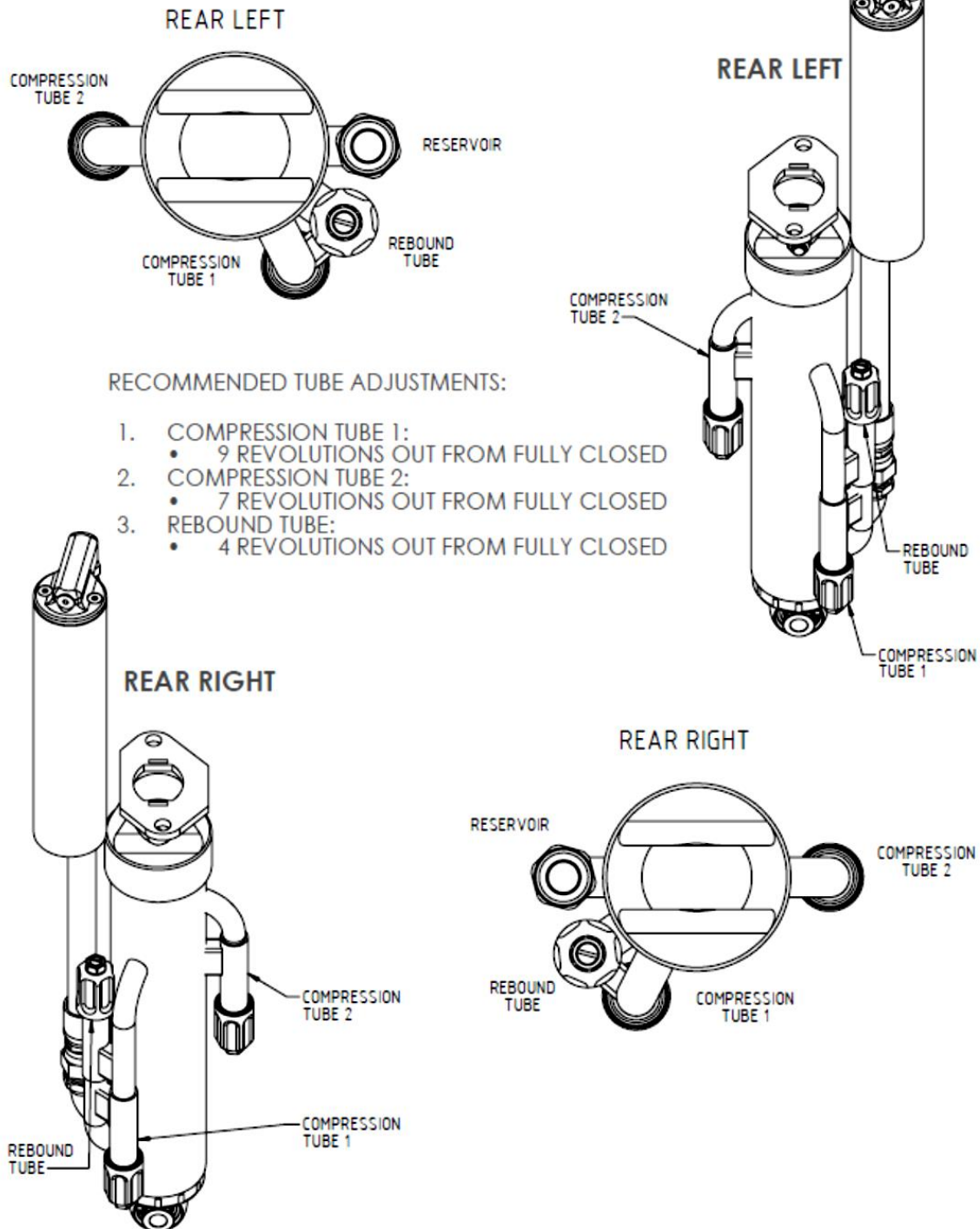

IMPORTANT: Read all instructions thoroughly from start to finish before beginning the install. Check parts list and make sure all parts are included in the kit. If the instructions are not properly followed severe frame, driveline and/or suspension damage may result. Check for frame and suspension damage prior to installation.

This kit does not require welding. Do not weld on any component. Welding may void the warranty and/or cause the product to fail. If any parts are missing, or for tech assistance; Contact King Off Road Racing Shocks: 714-530-8701. Most important after the install, Feel the difference and have fun.